

- Coaxial line with 2.92 Female connectors (K connectors)
- Small Size and lightweight
- Screw fixing without flange

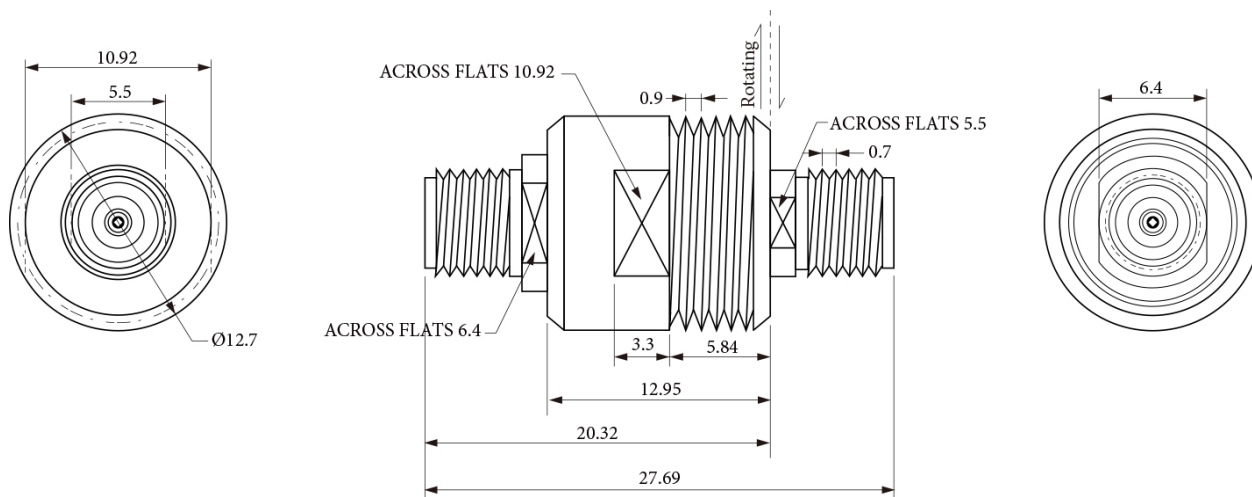

Specifications

Specifications			
Interface Type	2.92 Female (50 ohms)	Style	I Type
Frequency Range	DC to 40 GHz	Phase WOW (Degrees Max.)	1°
VSWR, Max.	1.30 @ DC to 10 GHz 1.45 @ 10 to 20 GHz 1.60 @ 20 to 30 GHz 1.75 @ 30 to 40 GHz	Insertion Loss, ,Max.	0.25 dB @ DC to 10 GHz 0.40 dB @ 10 to 20 GHz 0.55 dB @ 20 to 30 GHz 0.70 dB @ 30 to 40 GHz
VSWR WOW	0.1	Insertion Loss WOW	0.02 dB
Peak Power, Max.	500 W	Average Power, Max.	60 W @ 1 GHz
Rotating Speed, Max.	250 rpm	Life Time, Min.	5 Million Revolutions
Starting Torque	3.5 Ncm.	Continuous Rotational Torque	3.5 Ncm Max.
Axial Load On Interface, Max	± 1 N	Radial Load On Interface, Max.	± 1 N
Body Material	Stainless Steel	Contact Pin Material	Beryllium Copper
DC Power Ability	3 A * 24V @ Full RF Power	Contact Surface Finish	Gold Plate
Weight	0.014 kg	Marking	Adhesive Label
Insulator Material	PTFE / Teflon	IP Protection Level	IP 64 Per EN 60529
Temperature(Ambient Range)	-40 to +60 °C (Operation)	Humidity (Non-Condensing), Max.	85% (Operation)
	-50 to +70 °C (Storage)		95% (Storage)